



LA MARINA

SAMAY RESORTS

WWW.SAMAY.COM



Información y reservas: Avda. de la Alegría s/n · E-03194 La Marina · Playas de Elche (Alicante) SPAIN · Telf.: (+34) 96 541 92 00
info@lamarinaresort.com · La Marina Sunlife, S.L. · B-54869474

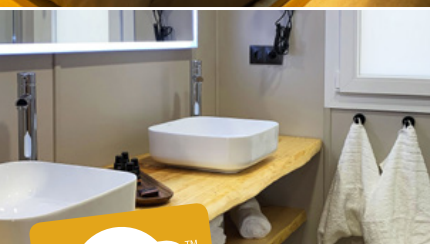
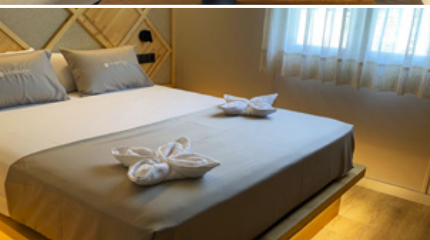

CAMPING RATE CALCULATION

DAILY PRICE = NUMBER OF ADULTS + NUMBER OF CHILDREN + PITCH

Electricity connection included for stays up to 60 nights. Electricity connection not included for stays of 61 nights or more: Payment according to kWh consumption.
Current year prices will be maintained for stays with arrival between September 1st and November 1st and departure until June 30th.
The low season rate will apply to stays longer than 90 nights, except from July 1st to August 31st.

LEADING PITCH > 125 m²



FULLY EQUIPED BATHROOM, KITCHEN WITH REFRIGERATOR
BARBECUE, GLASS-CERAMIC, MICROWAVE, SINK, PICNIC TABLE

MEALS

Buffet
BREAKFAST
12€ ADULT 7€ CHILD**

Breakfast
HB*+ Dinner
25€ ADULT 16€ CHILD**

FB*
35€ ADULT 25€ CHILD**

* Water and soft drinks included (Cocacola, Fanta orange, Fanta lemon, Sprite) ** 3 to 12 years old

PITCH INCLUDES



YELLOW
< 60M²

RED
60 ~ 80M²

BLUE
> 80M²

FRIDGE RENTAL

BOOKINGS 658 95 95 84

1 day: 10€ / +10 days: 9€/d.

Rentals for less than 3 days: 25€



CALCULATE YOUR BUDGET HERE →

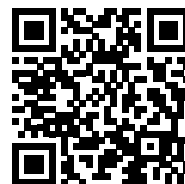



Bali Premium
Inside 56 m² Terrace 10 m²
*Various distributions available

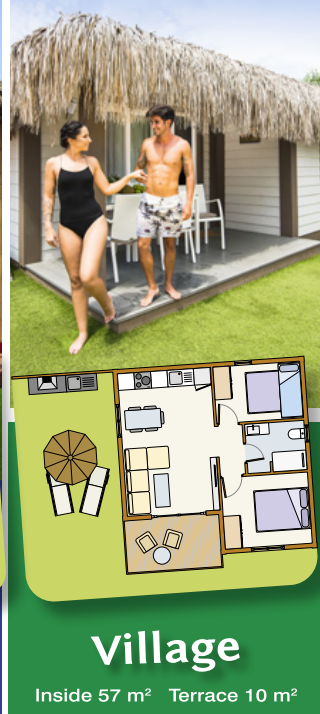

Village
Inside 57 m² Terrace 10 m²

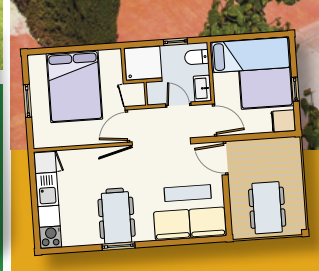
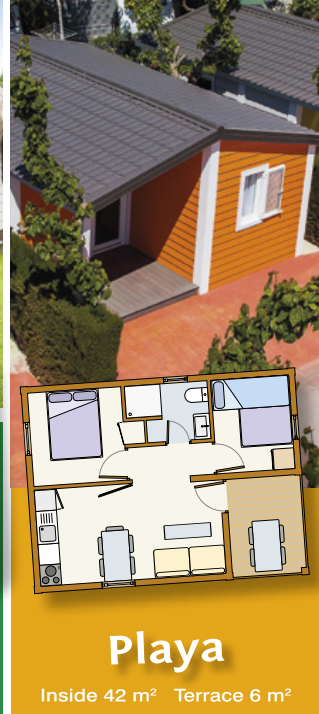

Playa
Inside 42 m² Terrace 6 m²

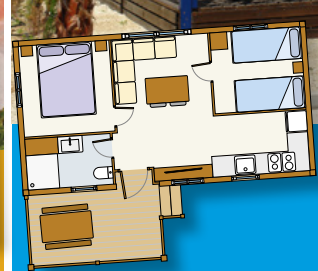

Oasis
Inside 43 m² Terrace 8 m²

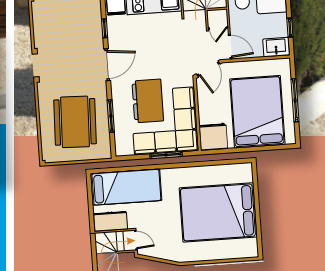
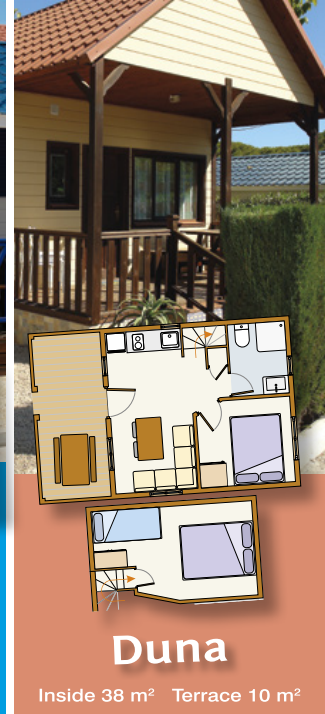

Duna
Inside 38 m² Terrace 10 m²



SPA & GYM
FREE ACCESS TO THE GYM FOR GUESTS

SPA · 1 ADULT SESSION	16€
SPA · 1 CHILD SESSION	10€
SPA · MONTHLY SUBSCRIPTION	40€
SPA · LONG STAY +30 DAYS <small>Mon-Fri afternoons + Sat and Sun.</small>	5€
SPA · LONG STAY + 30 DAYS <small>Mon-Fri - 9 AM to 2 PM.</small>	FREE

Check our website for the menu of massages, body and facial treatments.
www.marinasesences.com

GENERAL DESCRIPTION FOR BUNGALOWS

The bungalows have a bedroom with a double bed and a bedroom with a bunk bed plus a single bed. The bedrooms in the Duna model are distributed between a lower floor and an attic. All models have a bathroom with sink, shower, hairdryer, and WC, as well as a kitchen equipped with utensils, crockery, refrigerator, microwave, and coffee maker. They also include bed linen, towels, TV, air conditioning, and heating. The Bali and Marina Village bungalows have a barbecue. The Bali Premium model has an outdoor hot tub. One dog is allowed in the Neptuno, Mediterráneo, Duna, and Tabarca models. No pets are allowed in other models. A maximum of 4 people is allowed in the Neptuno model. Up to 7 people can be accommodated in the Marina Village and some Bali models (to be confirmed). A weekly cleaning service with a change of bed linen and towels is provided for stays of 8 nights or more. A towel change is included for stays of 3 nights or more. Extra cleaning and linen changes: Check price at reception. La Marina Resort applies dynamic rates that may change based on various criteria. Electricity consumption is included in the price except for stays of 30 nights or more.

A flat rate is available for stays longer than 30 nights between 01/10/2024 and 09/04/2025 and between 01/10/2025 and 26/03/2026.

PITCH RESERVATION CONDITIONS

ADVANCE PAYMENT (non-refundable): €100 per pitch.

La Marina Resort commits to reserving one pitch per owner, in the indicated category and upon written request, without guaranteeing a specific location. The client agrees to pay the full amount of the reserved stay upon arrival. The pitch will be available from 12:00 PM. Departure and end of use of facilities must always take place before 11:00 AM. Online check-in available to streamline the entry process.

BUNGALOW RESERVATION CONDITIONS

ADVANCE PAYMENT (non-refundable): 50% of the total estimated amount for refundable rates. 100% of the total estimated amount for non-refundable rates.

La Marina Resort commits to reserving one bungalow per owner, in the indicated category and upon written request, without guaranteeing a specific location. For refundable rates, the client agrees to pay the remaining balance upon arrival. A credit or debit card will be required to block a deposit of €100 (€200 for customers with pets) as a guarantee against potential damage or missing inventory upon departure. This deposit will only be refunded after inspection by the responsible staff, no earlier than 72 hours after check-out. On the arrival day, the bungalow will be available from 5:00 PM. Departure and end of use of facilities must always take place before 12:00 PM.

Online check-in available to streamline the entry process.

RESERVATION CANCELLATION APPLICABLE TO BUNGALOWS AND PITCHES

Only the reservation holder may process the cancellation by written request. When booking a non-refundable rate, the client pays 100% of the estimated amount in advance and waives the right to a refund or any subsequent modifications. For refundable rate cancellations:

- 31 days or more before the scheduled arrival date: 100% of the advance payment is refunded.
- Between 30 and 7 days before the scheduled arrival date: 50% of the advance payment is refunded.
- 6 days or less before the scheduled arrival date: No refund.
- Paid meal plans are non-refundable.

USEFUL INFORMATION

The reservation holder may make modifications by written request up to 30 days before the scheduled arrival date. It is mandatory to present an ID for the reservation holder and all accompanying guests aged 14 and older. For children between 0 and 13 years old without an ID, age must be verified with a family record book or other official document. Meal plans contracted for children between 0 and 13 years old without documentation will be charged based on the child's height.